

DEPARTMENT OF TRADE AND COMMERCE
STANDARDS BRANCH

OTTAWA, August 16, 1968.

APPROVAL LISTING

INDUSTRIAL BEAM VEHICLE SCALE

Under the provisions of the Weights and Measures Act, Chapter 292, R.S.C. 1952, and Regulations thereunder (P.C. 6894), the apparatus specified and illustrated herein have been listed as approved devices and may be used in Canada in accordance with the conditions applicable.

Apparatus Listed: A two section vehicle beam scale of the L lever design, models 40332, 40334, 40336, 40338, 40340, 40342, 40344, 40346, 40348, 40350, 50350, 50352, 50354, 50356, 50358, 50360, manufactured by the Manitoba Bridge and Engineering Works, 685 Logan Avenue, Winnipeg, Manitoba.

When the symbol B is used before the model number, it indicates the scale is equipped with a dumping device.

Rating of Apparatus: Models of the 403 series have a capacity of 81,000 pounds, and models of the 503 series have a capacity of 101,000 pounds.

Applications: To weigh loaded or unloaded vehicles in general trade use.

Conditions: As prescribed in P.C. 6894.

Descriptions: These devices are two section vehicle scales for permanent installation. They are of the L lever design with corner stands or suspension corners. The applicer arms are connected to a transfer lever with an extension arm which is connected to a full capacity beam by a steel yard rod. The deck may be either concrete, steel or wood planks, it may or may not be supplied with a dumping device. The balance ball adjustment is operated by a separate tool.

Testing: The standard tests for a vehicle scale shall apply.

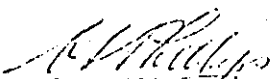
C. S. Phillips,
Chief, Weights and Measures Division,
Standards Branch.

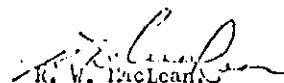
R. W. MacLean,
Director,
Standards Branch.

Reference: SL-102-693A.

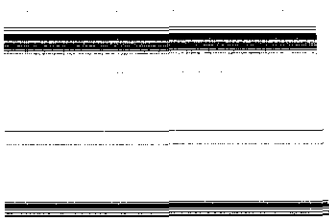

(

(

2

S-WA.519

DOMINION HEAVY DUTY TRUCK SCALE

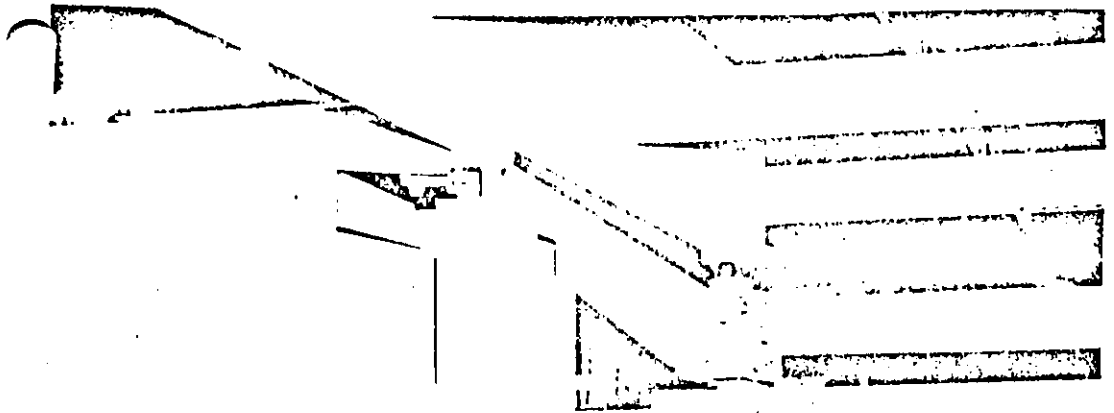
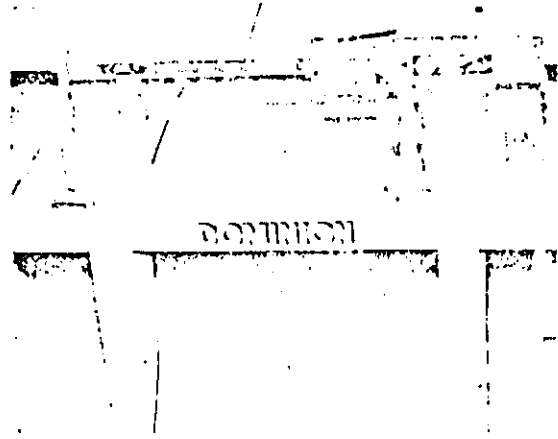

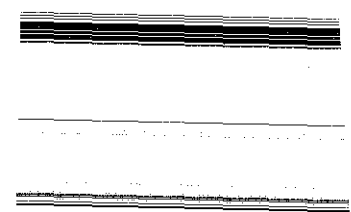

(

(

*